

KH Cloud assembly getting started

step 1

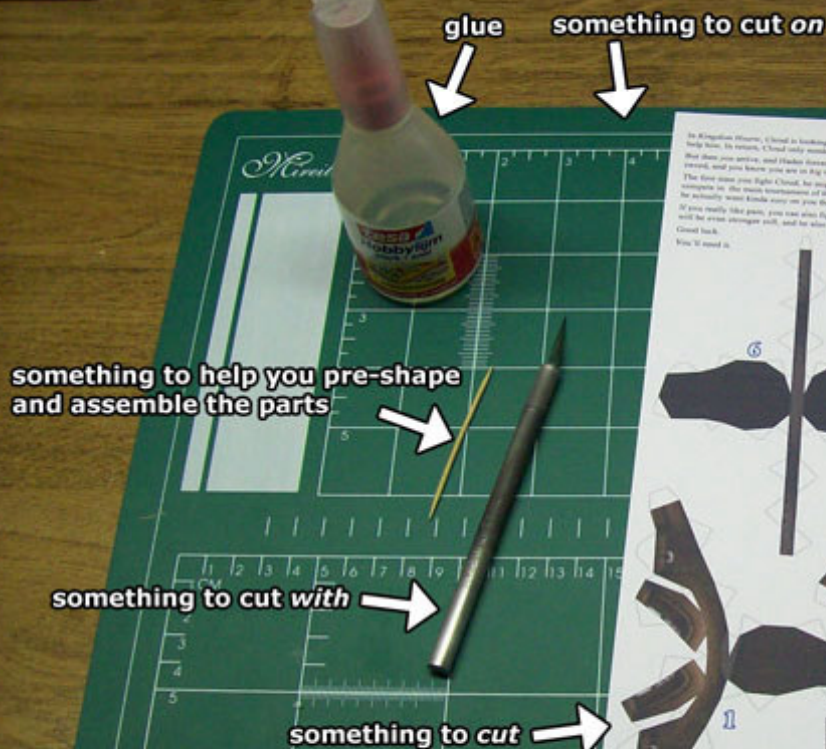

Gather all your papercrafting tools: glue, something to cut on, something to cut with, something to cut (print the parts on thicker paper) and something to pre-shape and assemble the parts.

KH Cloud assembly shoes

step 2



Start by cutting out and assembling part 1 (the sole and the sides first, then the two top flaps. At least that's how I did it ;o)

step 3

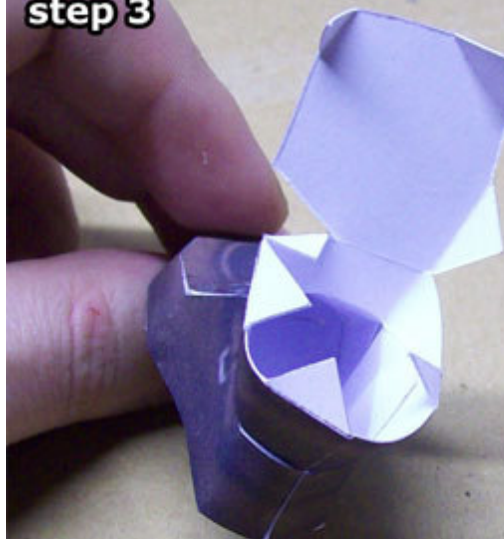

Then cut out part 2. Leave closing the top for last, so you can still reach inside while you glue it to part 1.

step 4



Cut out and assemble part 3. The logo goes on the bottom.

step 5



Now glue part 3 underneath part 1. It's a bit wider and longer than part 1: align the tip, and try to let the rest stick out equally on the other sides.

step 6



Now just repeat steps 2-5 for parts 4-6 to make the other shoe. ;o)

KH Cloud assembly

legs

step 7



Cut out and assemble part 7.
(yours will have a "this side up" text)

step 8

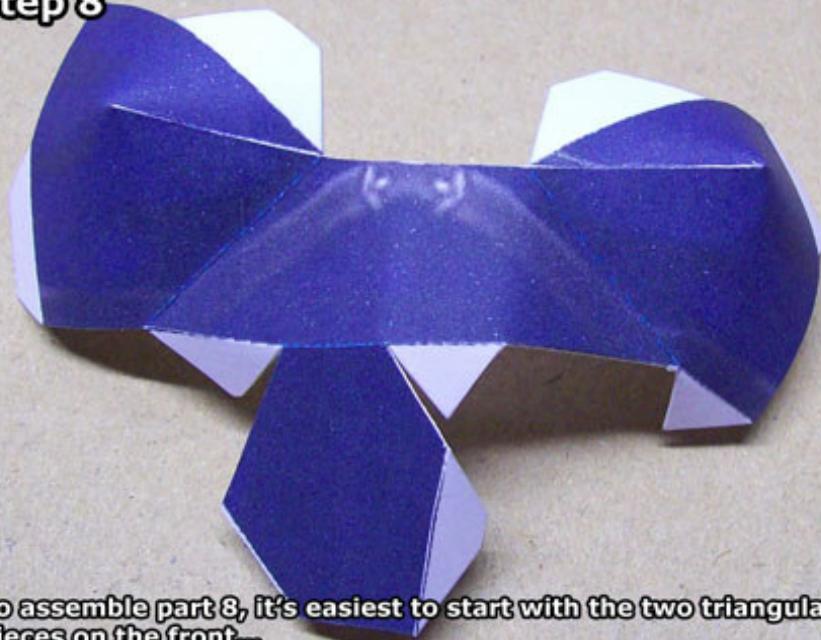

To assemble part 8, it's easiest to start with the two triangular pieces on the front...

step 9

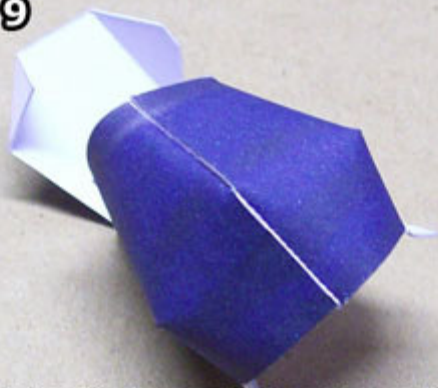

...then bring the two ends together at the back,
and leave the bottom for last.

step 10



Cut out and glue on part 9 and again, leave the
top for last.

step 11



Assemble part 10 (yours will have a "this side up" text
again) and glue the pieces you've assembled so far together.
Make sure to align the seams at the back!

step 12

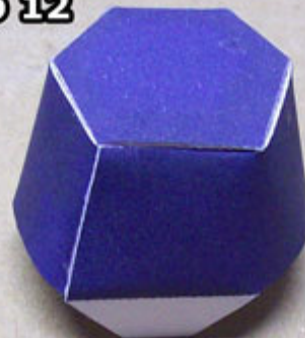

Continue by assembling part 11.

step 13



Then glue on parts 12 and 13, in that order. Fold the glueing tab marked "A" all the way flat.

step 14

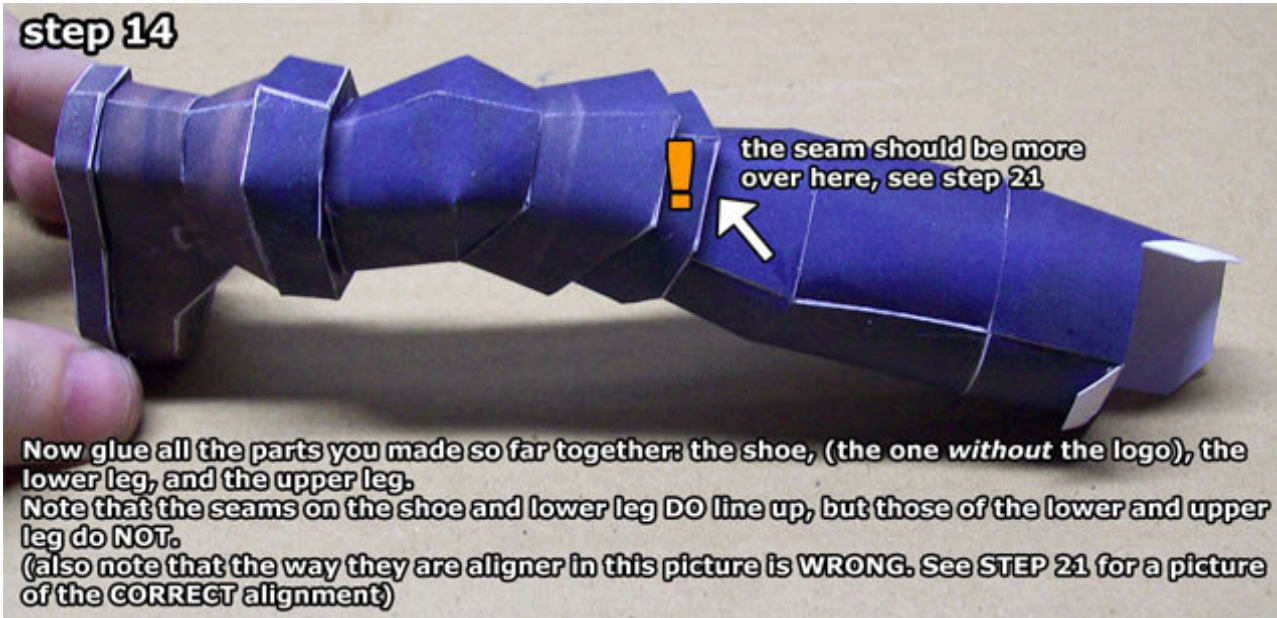

Now glue all the parts you made so far together: the shoe, (the one *without* the logo), the lower leg, and the upper leg. Note that the seams on the shoe and lower leg DO line up, but those of the lower and upper leg do NOT. (also note that the way they are aligner in this picture is WRONG. See STEP 21 for a picture of the CORRECT alignment)

step 15

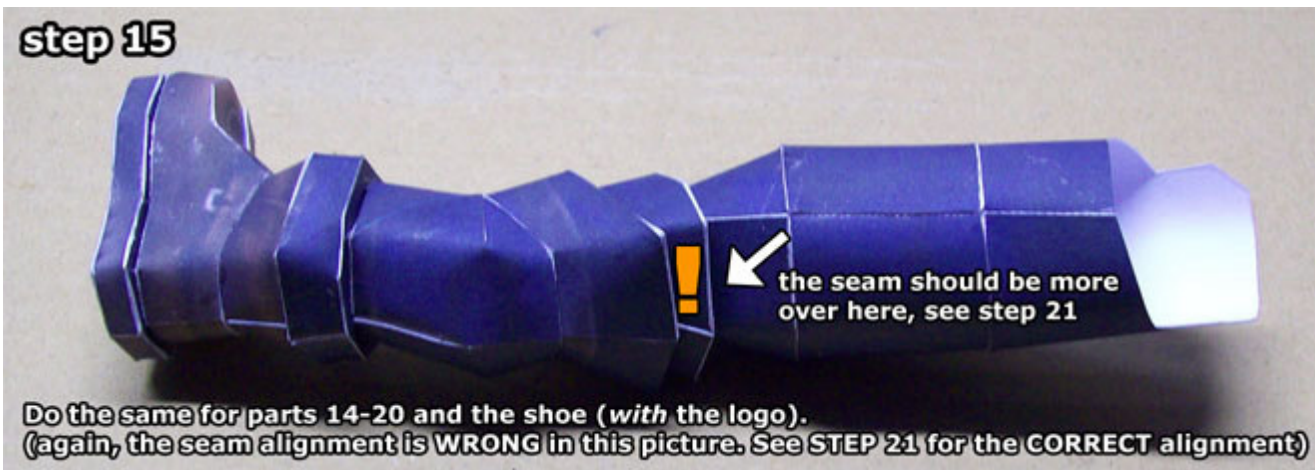

Do the same for parts 14-20 and the shoe (*with* the logo). (again, the seam alignment is WRONG in this picture. See STEP 21 for the CORRECT alignment)

step 16

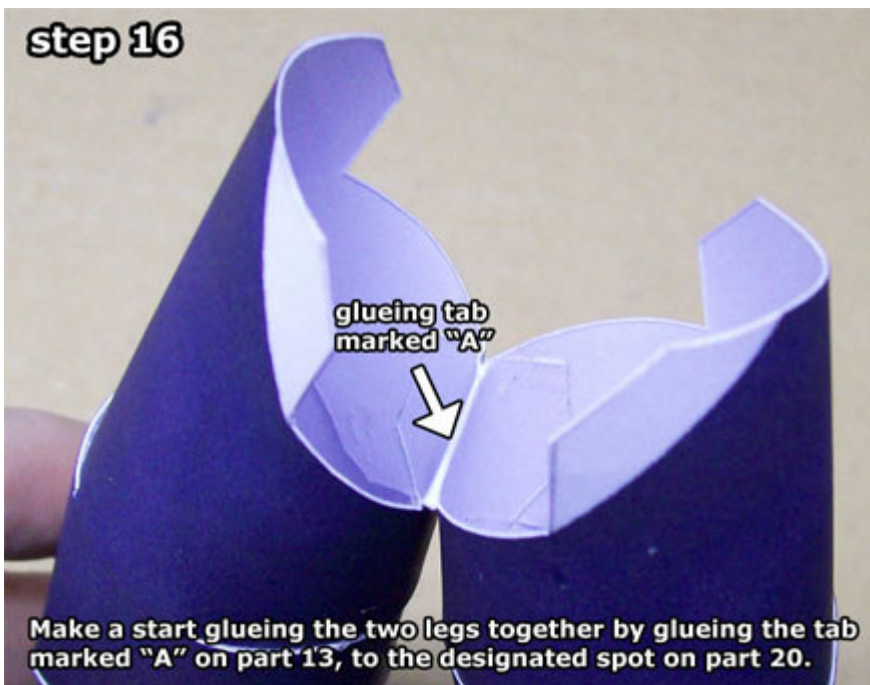

step 17



step 18



step 19



step 20



step 21

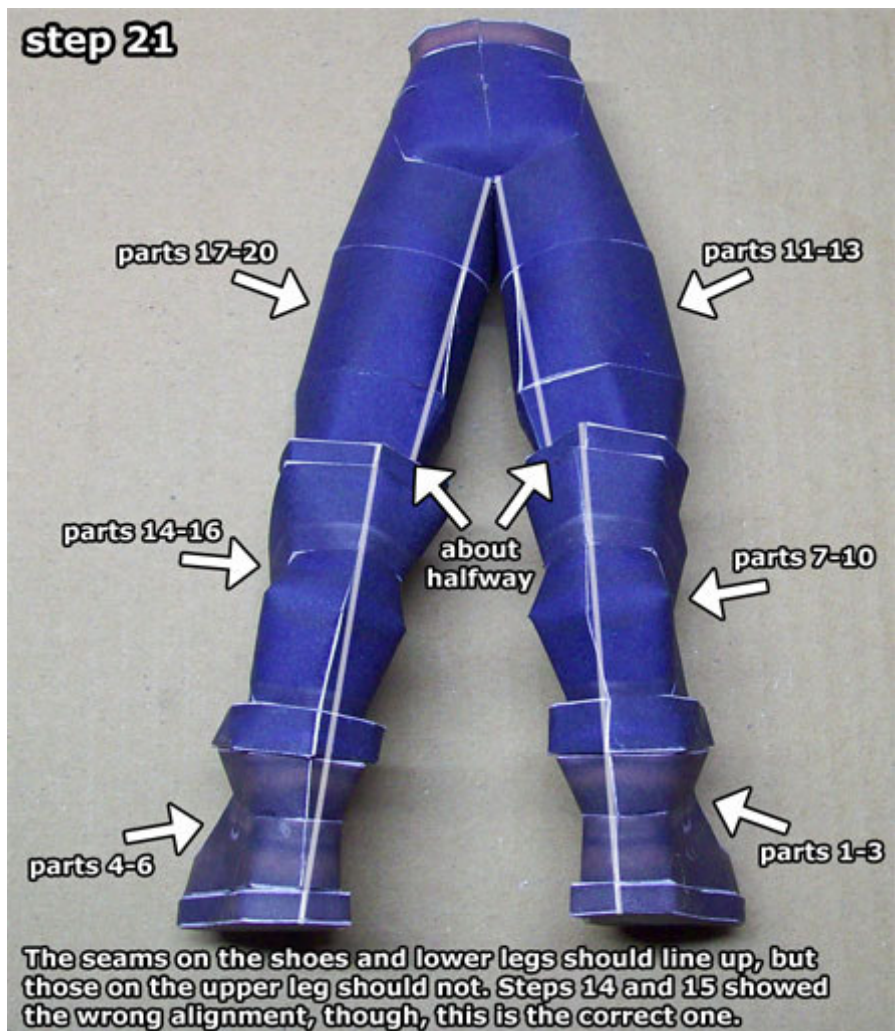

KH Cloud assembly belts+armor pieces

step 22



Cut out and pre-shape parts 25-27 so that they remain curved (they should fit around Cloud's upper leg).

step 23



To glue these three parts together, only use a roll of glue on the top edge of parts 25 and 26.

step 24

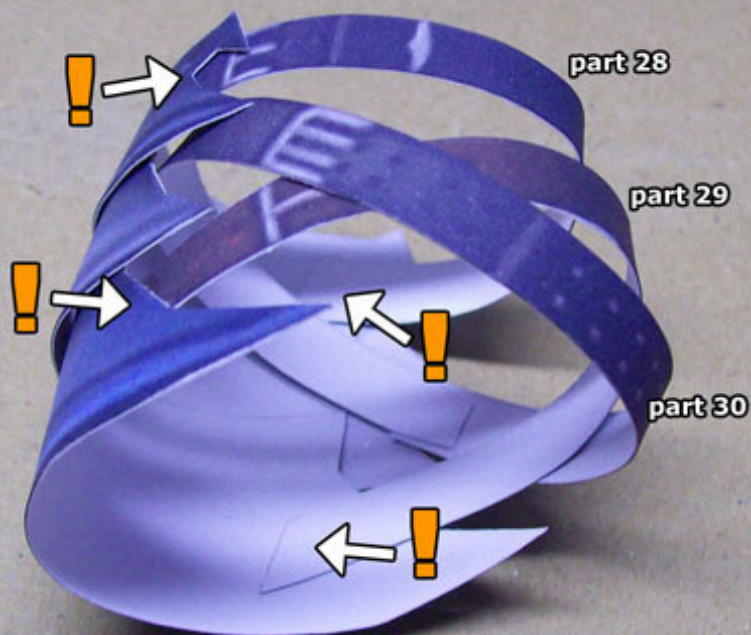

Cut out and pre-shape parts 28 and 29. Put a small dab of glue on the ends to glue these parts to the armor pieces as shown here. Part 29 glues into a ringshape and doesn't really need to be glued to the armor pieces, but you can if you want to of course. ;o)

step 25



Now you can just slide the armor pieces over Cloud's hips. I think it looks better if you DON'T use any glue, but of course you can if you want to. ;o)

KH Cloud assembly torso+arms

step 26

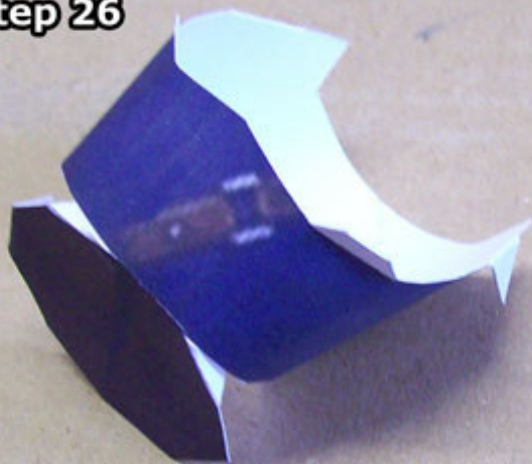

Glue together the ends of part 31, but leave the bottom open for now.

step 27



Cut out and glue together part 32...

step 28

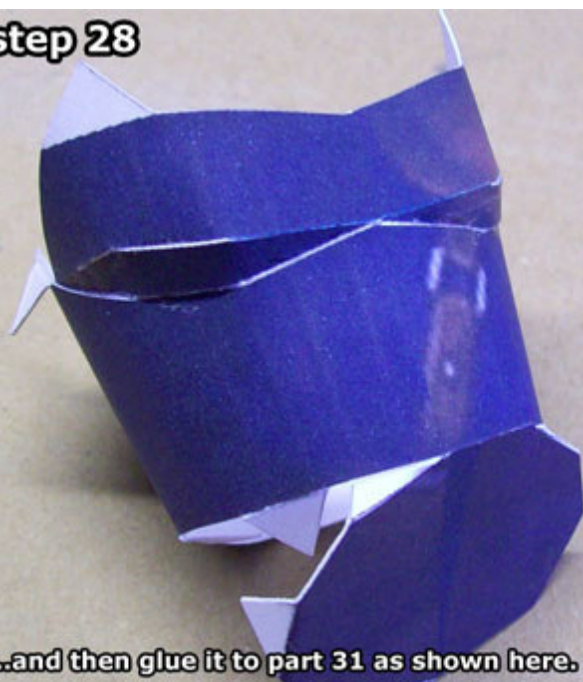

...and then glue it to part 31 as shown here.

step 29



Continue by glueing part 33 to the front...

step 30

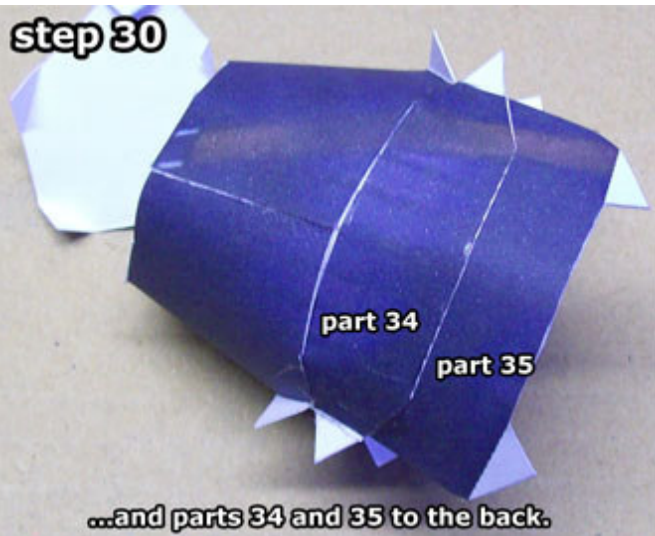

step 31

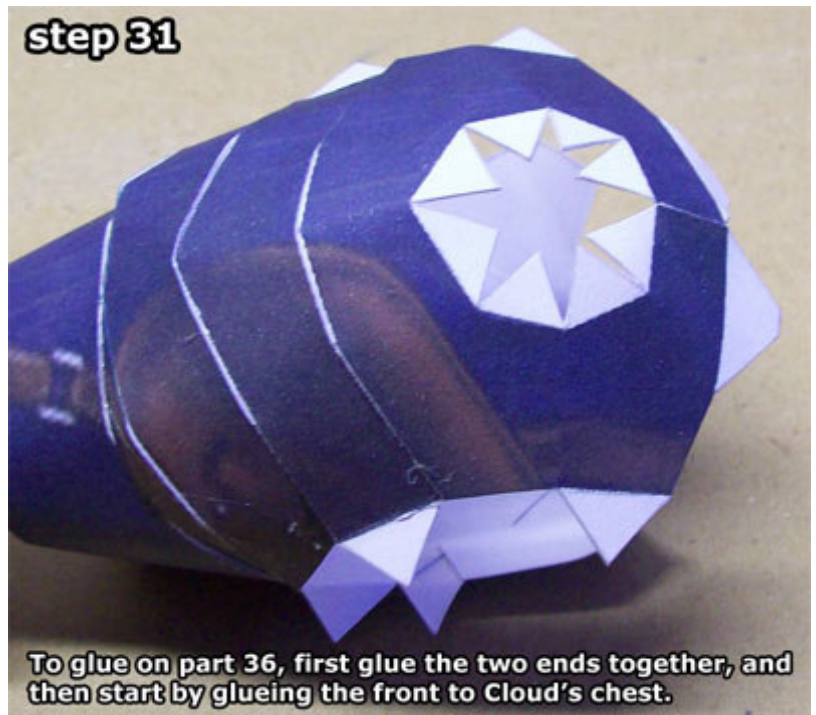

step 32

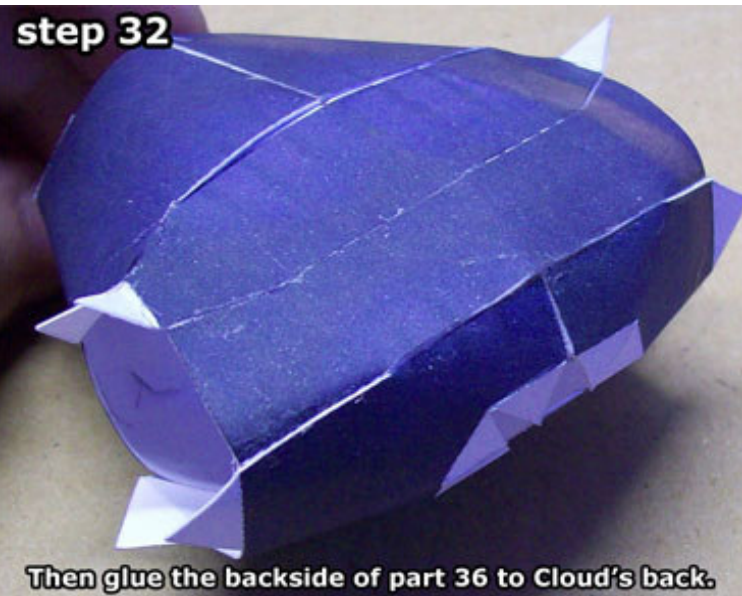

step 33

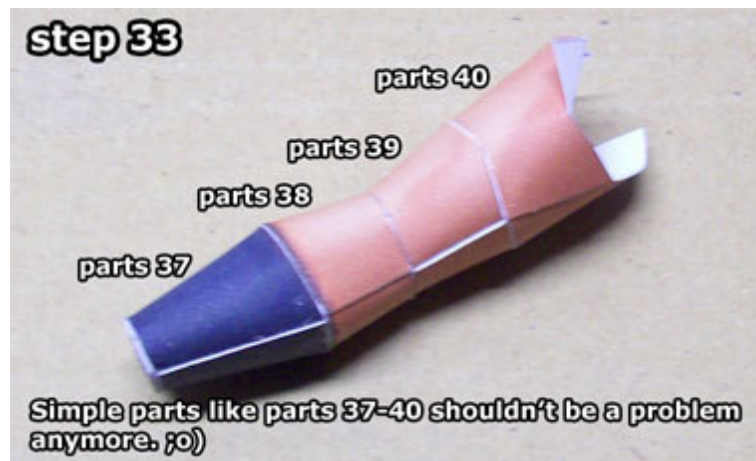

step 34



step 35



step 36





KH Cloud assembly

Rhand

step 37

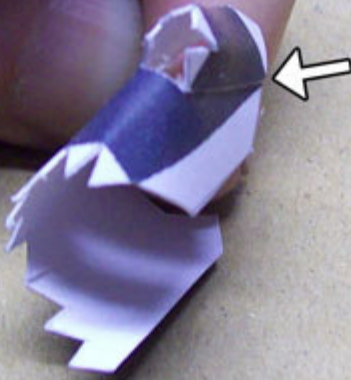

To assemble part 47, I found it easiest to pre-shape it, and then first glue the glue tab on the base for the thumb as shown here....

step 38

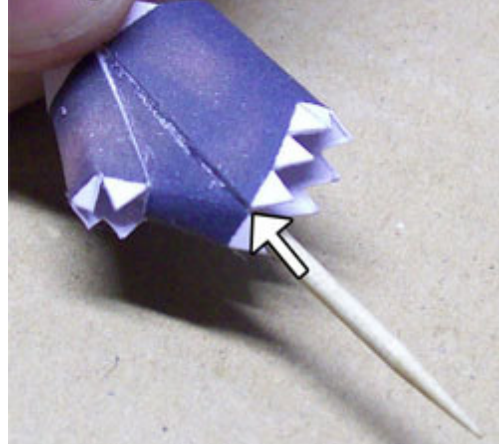

...and then the other one like this.

step 39



Now assemble and glue on part 48.

step 40



The fingers (or in this case, the thumb) may look small, but they're not very difficult to make if you take your time:
<http://www.youtube.com/watch?v=3ph7ayEs1RA>

Use a toothpick or some other small rod to pre-shape and assemble part 49 and glue it on as shown here.

step 41



Do the same for part 50 (this one has a closed top) and glue it to part 49.

step 42



For glueing on the rest of the fingers, I think it's easiest if you first glue the two parts of each finger together (in this case parts 51 and 52)...

step 43



three glueing
tabs to glue on
the finger

...and then glue the finished finger over the glueing tabs on part 47. In this case, the 3 glueing tabs on the end opposite to the thumb, as shown here. The small glueing tab on the finger itself will serve to glue on the next finger.

step 44

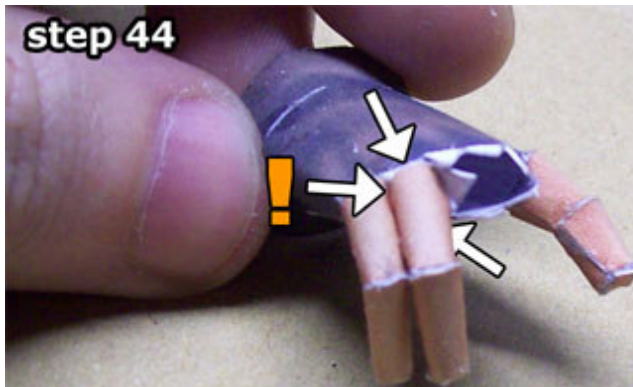

Do the same for parts 53 and 54. This time, use two of the glueing tabs from the hand (top and bottom) and the small one from the other finger (on part 51).

step 45



Here's a view from the other side, parts 55 and 56 glue on the same way as the previous finger: two glueing tabs from the hand on the top and bottom, and one small glueing tab from part 53.

step 46



Parts 57 and 58 glue to three glueing tabs from the hand (top, bottom, and the one at the end) and the small one from part 55.

step 47



Try to do your best, but don't panic if it's not perfect. I also just put a drop of glue inside the end of the fingers, and then press them onto the small glueing tabs of the hand. And when they hang on, I let them be. ;o)
When you're happy with the hand, adjust the fingers so they're in a "sword holding" position, and glue the hand to the wrist (check the thumb to see on which arm ;o)



KH Cloud assembly

Lhand

step 48



Assemble part 59 the same way you did part 47, meaning pre-shape it first, then first glue the glueing tab for the base of the thumb...

step 49

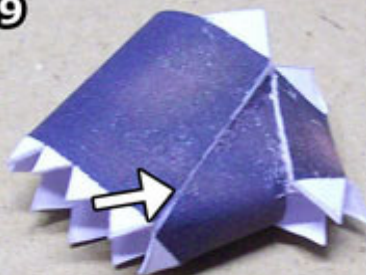

...and then the other big one, as indicated by the arrows on the template.

step 50



Now glue on part 60.

step 51



Part 61 is a small cylinder again, like all the other fingers you made so far.

step 52



Part 62 however is a small cone. Making small cones it not really much more difficult than making small cylinders though: <http://www.youtube.com/watch?v=kAb8jzFh80s>

step 53



The rest of the fingers are probably easier to glue to the hand already assembled again (like parts 63 and 64 in this picture).

step 54



This time, start with the three glueing tabs closest to the thumb.

step 55



Glue on the other fingers (parts 65-70) the same way as you did on the other hand, and then glue this hand to Cloud's left wrist.

KH Cloud assembly cloak+wing

step 56

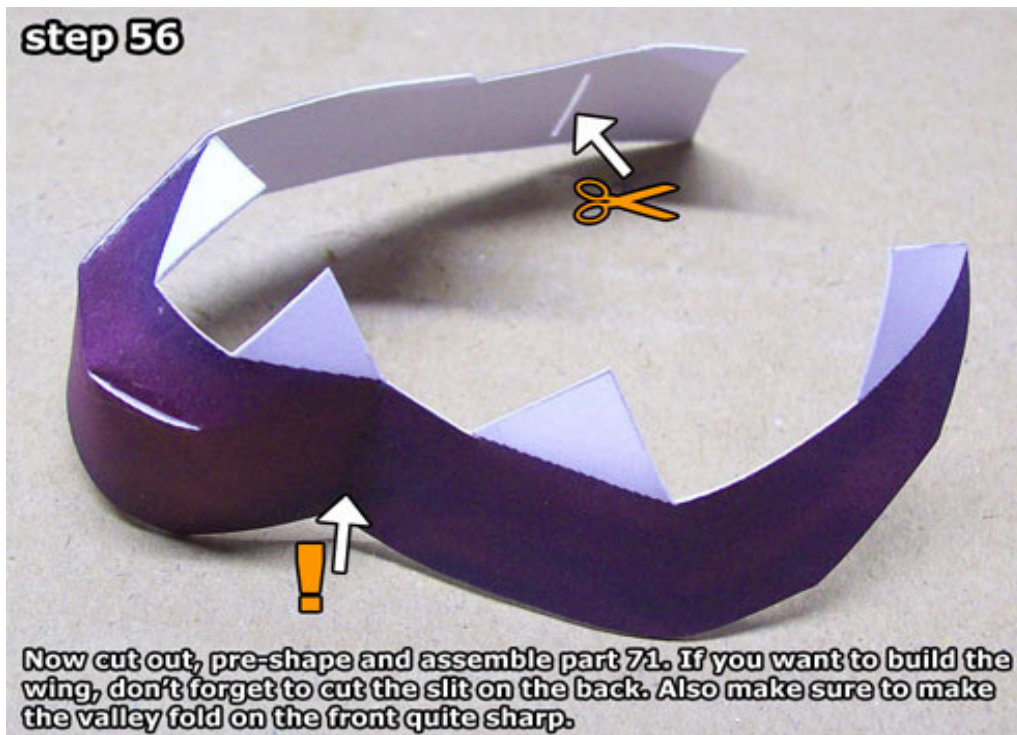

step 57



step 58



Now glue on part 73. Fold back the glueing tabs on the rim all the way back.

step 59



Cut out and assemble part 74 as shown here. (meaning, assemble it with the coloured side in ;o)

step 60



Now glue it inside part 73. Take care to align the edges, so that it looks nice enough for you. ;o)

step 61

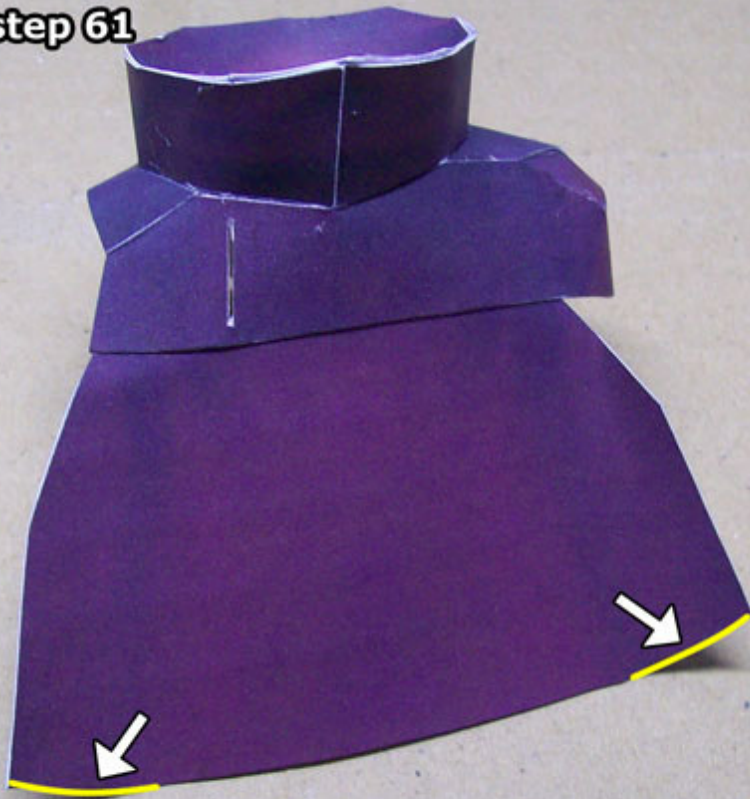

Cut out part 75 and glue it onto the backside. Give the sides a little "curve".

step 62



Do the same for parts 76 and 77. The "curves" not only look nice, they will also help the parts fit together properly.

step 63



Parts 78 and 79 are mirror images; glue them back-to-back, but DON'T glue the two glueing tabs together!

step 64



Instead, push the two glueing tabs through the slit on part 71, fold them back and glue them to the backside of part 71.

step 65

If you want to, you can cover up the backside of the cloak with parts 80-82 (glue them on one by one, or all at once after glueing thm together. It's probably best if you print these parts on regular printer paper instead of thicker cardstock.

step 66



You should be able to glue the flat part inside part 74 onto the grey glueing tabs of part 36. If you're having trouble put some glue on the shoulders and chest as well.

step 67



Now assemble and glue on part 83 by simply putting a few dabs of glue in three or four strategic places on Cloud's left shoulder.



KH Cloud assembly head+hair

step 68



Cut out and pre-shape part 84. Take care assembling the ears.

Step 69



Next, cut out and glue on parts 85...

step 70



...86...

step 71

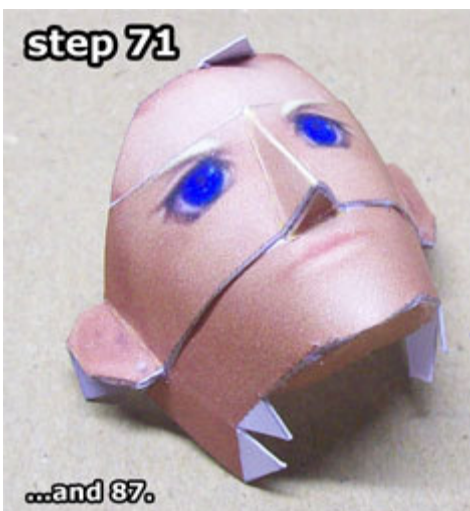

...and 87.

step 72

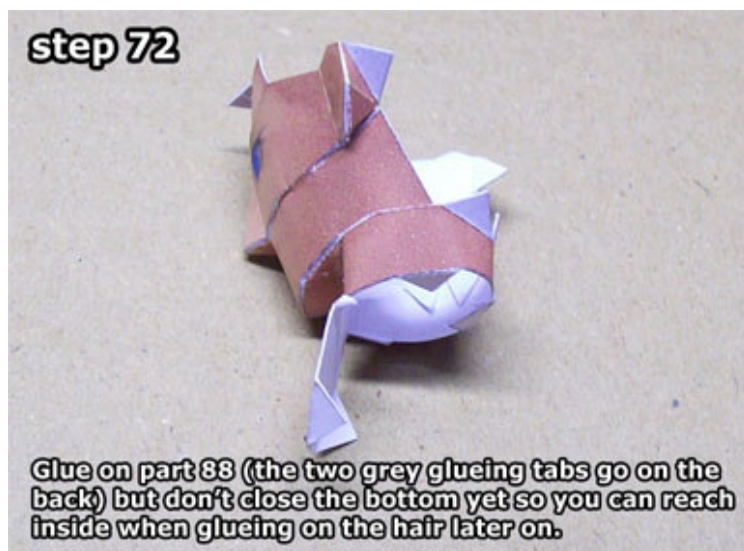

Glue on part 88 (the two grey glueing tabs go on the back) but don't close the bottom yet so you can reach inside when glueing on the hair later on.

step 73

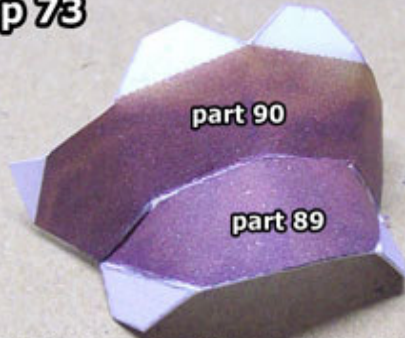

The first two parts of the hair (part 89 and part 90) are easy (if you make the valley folds right :o)

step 74



All the arrows and markings on the template may look intimidating, but try to only cut out and assemble one part at a time, so you don't get confused.

I found it easiest to make the "spikes" first, then pre-shape (valley- and mountainfold it) first and then glue it to the previous part(s).

On part 91, both "spikes" need to be folded back almost flat against the hair.

step 75



Then glue part 91 to part 90. Take extra care on the sides (indicated by the two arrow lines on the template) because there is a lot of tension because of the way you need to fold them.

step 76

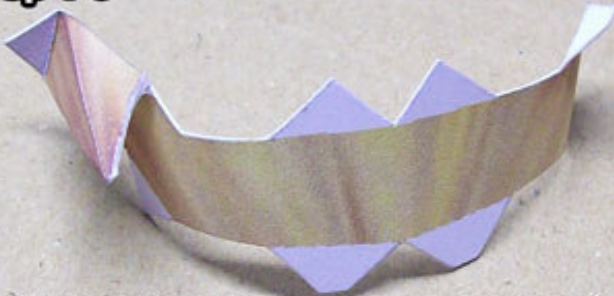

Assemble part 92 the same way as part 91: first make the "spike", then pre-shape the part...

step 77

glueing tab "G"



...and then glue it to part 91.

step 78



Part 93 is easier to glue on again, just don't mix up the top and the bottom (glue it on the way it is on the template).

step 79

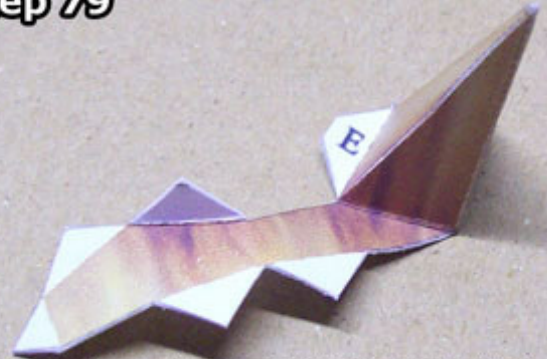

On part 94, again assemble the spike first...

step 80



...and then glue it to parts 92 and 93. Pay close attention to the arrow lines on the template, and for the rest, just use your mind. ;o)

step 81



Assemble the spike on part 95...

step 82



...then follow the arrow lines again to figure out how to glue it to the rest of the hair.

step 83

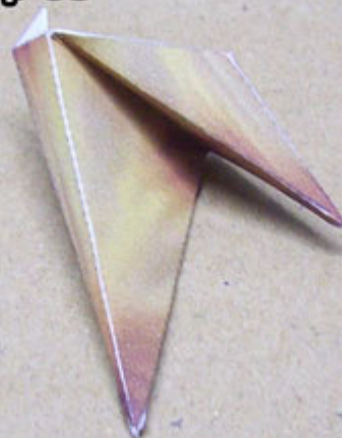

Make two spikes out of part 96, and fold them close against each other.

step 84



Glue it to the rest of the hair. Use a toothpick to press the valley folded glueing tabs firmly against the inside of the spikes.

step 85

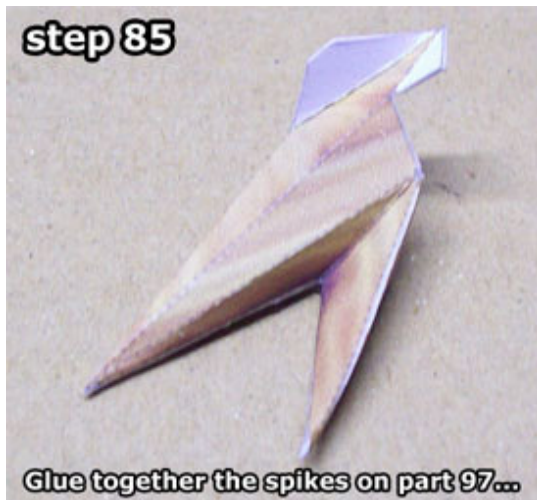

Glue together the spikes on part 97...

step 86



...then glue part 97 to the rest of the hair. Take your time to fold and glue all the glueing tabs properly.

step 87



Part 98 is the last part of the hair. Gue together the spikes, and pre-shape the valley folds on the two sides of the small triangular part in the middle.

step 88



Now glue part 98 to the rest of hair. That's it, you finished the hair. ;o)

step 89

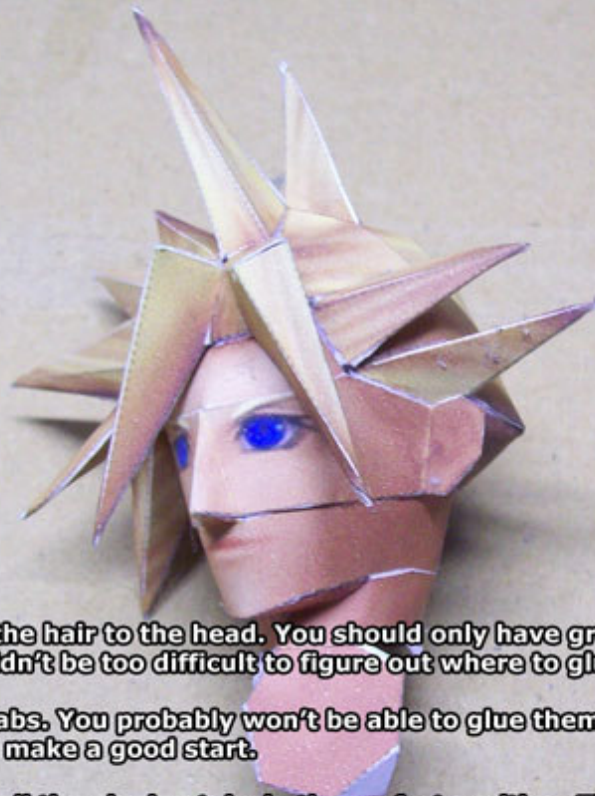

The hardest part is glueing the hair to the head. You should only have grey glueing tabs left (if not, you missed one, but it shouldn't be too difficult to figure out where to glue it now ;o)

Put glue on all the glueing tabs. You probably won't be able to glue them in the perfect position all at once in one go, but it will make a good start.

Don't worry if you can't get all the glueing tabs in the perfect position. The hair will stay on even if not all of the glueing tabs are glued together properly.

I found it easiest to first do the backside, then the front, and then the sides near the ears one at a time. Use the hole on the bottom of the neck you left open to reach inside with a toothpick or something similar to adjust the glueing tabs from the inside.

step 90



KH Cloud assembly buster sword

step 91

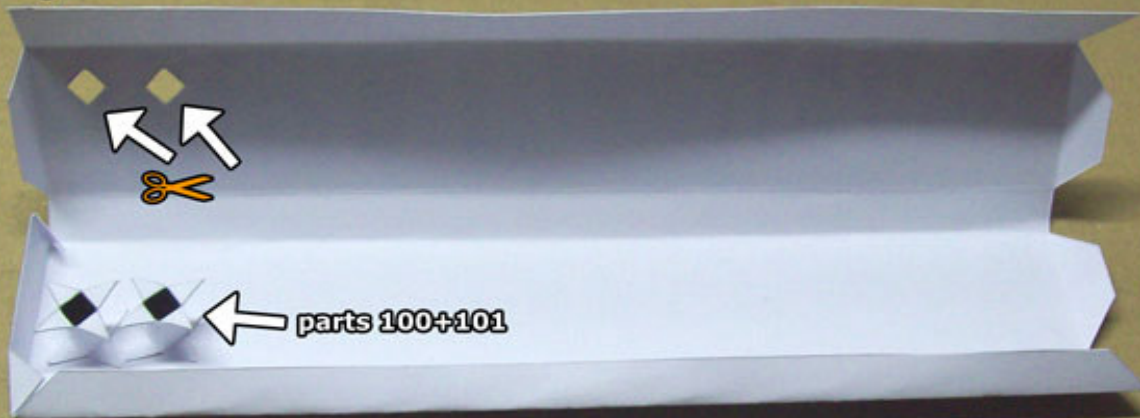

Don't forget to cut out the four square holes on part 99, and before closing it, glue in place parts 100 and 101 (assemble these with the coloured side in).

step 92



After closing part 99, glue on the tip of the blade (part 102).

step 93



Now assemble part 103 and glue it onto the back of the blade. Push the glueing tabs inwards.

step 94

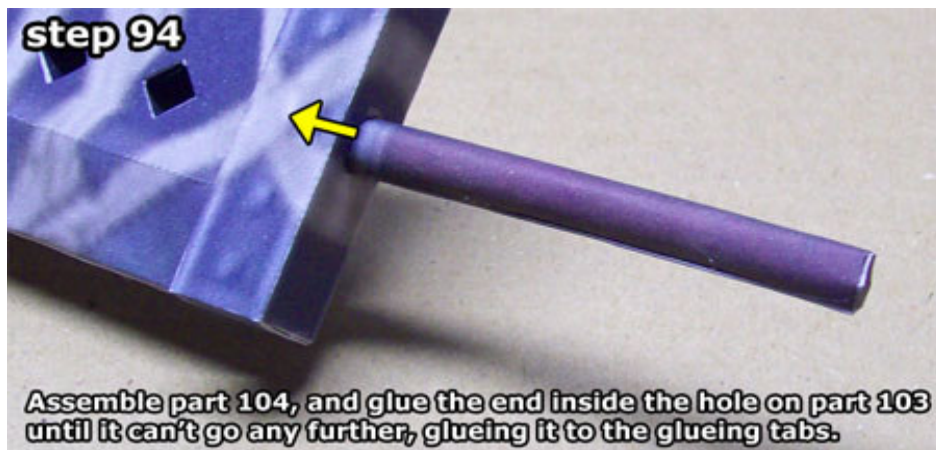

Assemble part 104, and glue the end inside the hole on part 103 until it can't go any further, glueing it to the glueing tabs.

KH Cloud assembly final assembly

step 95



You can try adjusting the fingers to have Cloud holding the sword, but the easiest way is just to glue it to his hand. Your model will probably be much better balanced now, but take a look at <http://www.youtube.com/watch?v=l0vipHZdadE> to see what you can do if it still falls over.

Thank you for downloading and building a Ninjatoes' papercraft model!

www.kickme.to/ninjatoes